

# REMOTE CONTROL

# OWNER'S MANUAL



**IMPORTANT NOTE:**

Thank you for purchasing our air conditioner. Please read this manual carefully before operating your new air conditioning unit. Make sure to save this manual for future reference.

# Table of Contents

<b>Remote Control Specifications .....</b>	<b>02</b>
<b>Handling the Remote Control .....</b>	<b>03</b>
<b>Buttons and Functions .....</b>	<b>04</b>
<b>Remote Screen Indicators .....</b>	<b>05</b>
<b>How to Use Basic Functions .....</b>	<b>06</b>
<b>How to Use Advanced Functions .....</b>	<b>09</b>

# Remote Control Specifications

<b>Model</b>	RG51G(1)/CEFU1, RG51G(1)/EFU1, RG51G1(1)/EFU1, RG51G4(1)/EU1, RG51G5(1)/EU1, RG51G4(1)/CEU1, RG51G5(1)/CEU1
<b>Rated Voltage</b>	3.0V( Dry batteries R03/LR03 × 2)
<b>Signal Receiving Range</b>	26.24 FT
<b>Environment</b>	23°F~140°F (-5°C~60°C)

## Quick Start Guide

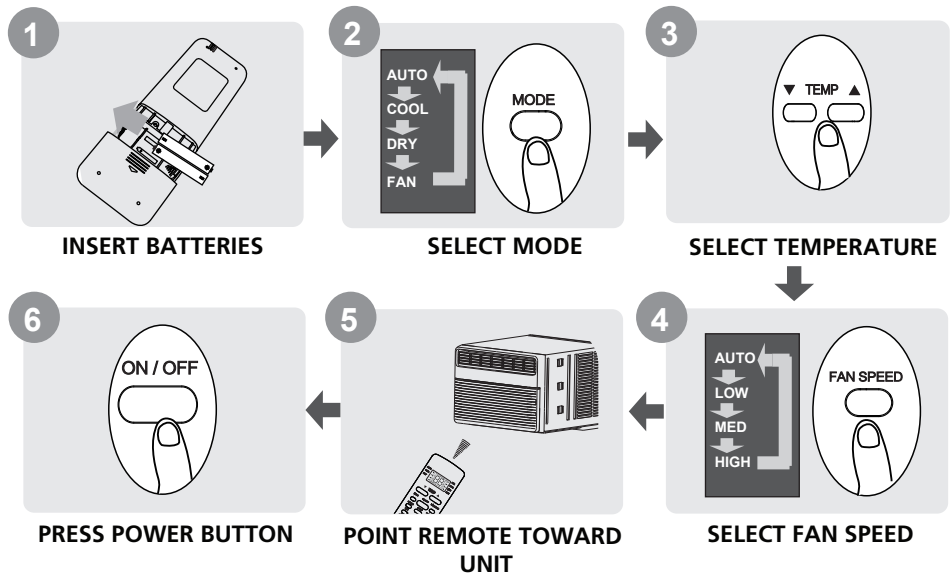

## NOT SURE WHAT A FUNCTION DOES?

Refer to the **How to Use Basic Functions** and **How to Use Advanced Functions** sections of this manual for a detailed description of how to use your air conditioner.

## SPECIAL NOTE

- Button designs on your unit may differ slightly from the example shown.
- If the indoor unit does not have a particular function, pressing that function's button on the remote control will have no effect.
- When there are wide differences between "Remote control Manual" and "USER'S MANUAL" in the function description, the description of "USER'S MANUAL" shall prevail.

# Handling the Remote Control

## Inserting and Replacing Batteries

Your air conditioning unit may come with two batteries. Insert the batteries in the remote control before use.

1. Slide the back cover from the remote control downward, exposing the battery compartment.
2. Insert the batteries, paying attention to align the (+) and (-) ends of the batteries with the symbols inside the battery compartment.
3. Slide the battery cover back into place.

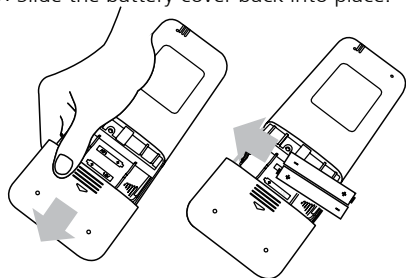

## NOTES FOR USING REMOTE CONTROL

The device could comply with the local national regulations.

- In Canada, it should comply with CAN ICES-3(B)/NMB-3(B).
- In USA, this device complies with part 15 of the FCC Rules. Operation is subject to the following two conditions:
  - (1) This device may not cause harmful interference, and
  - (2) this device must accept any interference received, including interference that may cause undesired operation.

This equipment has been tested and found to comply with the limits for a Class B digital device, pursuant to part 15 of the FCC Rules.

These limits are designed to provide reasonable protection against harmful interference in a residential installation.

This equipment generates, uses and can radiate radio frequency energy and, if not installed and used in accordance with the instructions, may cause harmful interference to radio communications.

However, there is no guarantee that interference will not occur in a particular installation. If this equipment does cause harmful interference to radio or television reception, which can be determined by turning the equipment off and on, the user is encouraged to try to correct the interference by one or more of the following measures:

- Reorient or relocate the receiving antenna. Increase the separation between the equipment and receiver.
- Connect the equipment into an outlet on a circuit different from that to which the receiver is connected.
- Consult the dealer or an experienced radio/TV technician for help.
- Changes or modifications not approved by the party responsible for compliance could void user's authority to operate the equipment.

## ! BATTERY NOTES

For optimum product performance:

- Do not mix old and new batteries or batteries of different types.
- Do not leave batteries in the remote control if you don't plan on using the device for more than 2 months.



## BATTERY DISPOSAL

Do not dispose of batteries as unsorted municipal waste. Refer to local laws for proper disposal of batteries.

## TIPS FOR USING REMOTE CONTROL

- The remote control must be used within 26.24 FT of the unit.
- The unit will keep when remote signal is received.
- Curtains, other materials and direct sunlight can interfere with the infrared signal receiver.

# Buttons and Functions

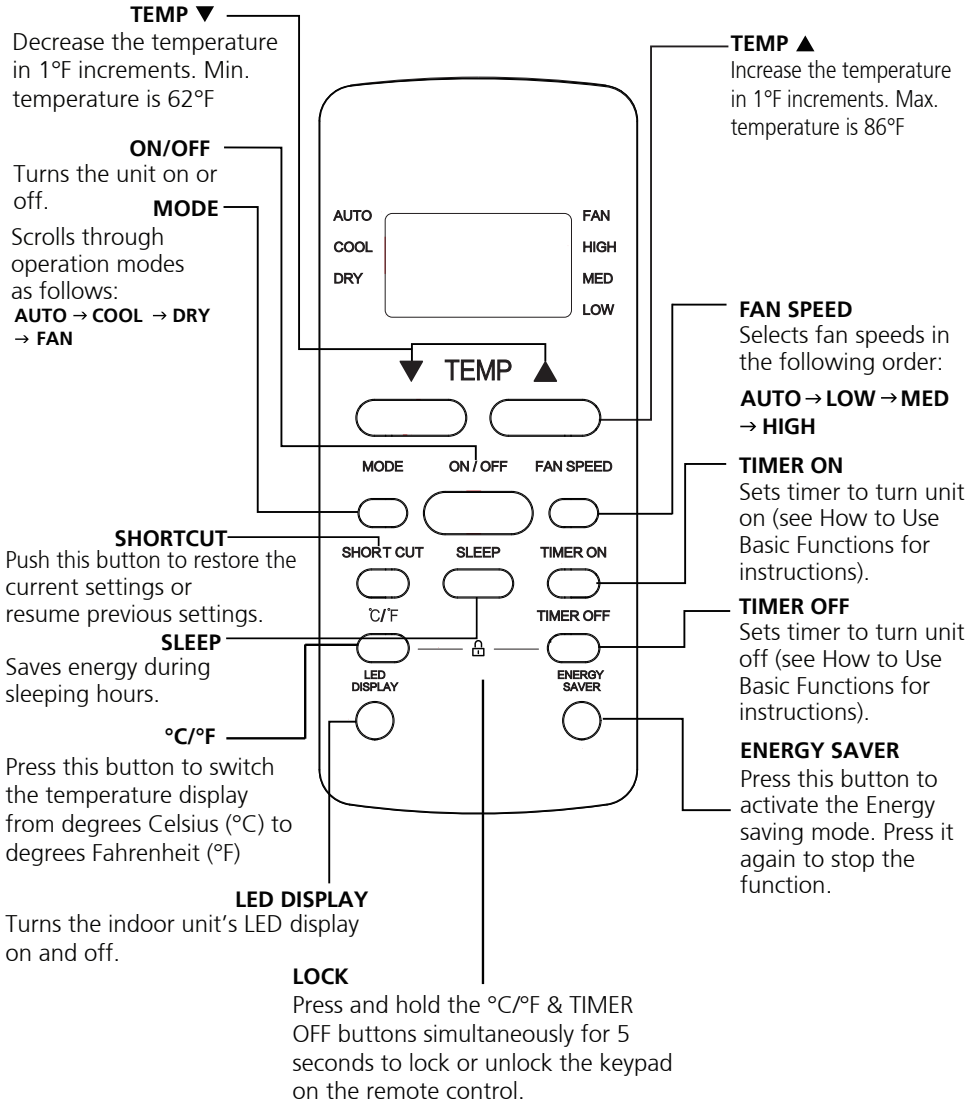





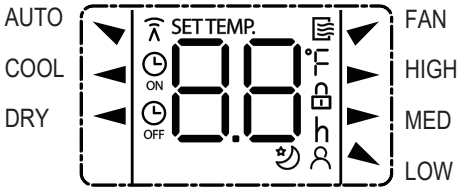

## Remote Screen Indicators

Information is displayed when the remote control is power up.



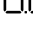

### Mode display



-  Displayed when data transmitted.
-  Displayed when remote control is ON.
-  Displayed when TIMER ON is set
-  Displayed when TIMER OFF is set
-  <sup>SET TEMP.</sup>  <sub>h</sub> Displays the set temperature by default, or timer setting when using TIMER ON/OFF functions
-  Indicate the remote control is locked
-  Displayed when SLEEP function is activated

### Fan speed indication

-  HIGH High speed
-  MED Medium speed
-  LOW Low speed
- NO display Auto fan speed

### Note:

All indicators shown in the figure are for the purpose of clear presentation. But during the actual operation, only the relative function signs are shown on the display window.

# How to Use Basic Functions

## Basic operation

### ATTENTION!

Before the operation, please ensure the unit is plugged in and power is available.

## COOL Mode

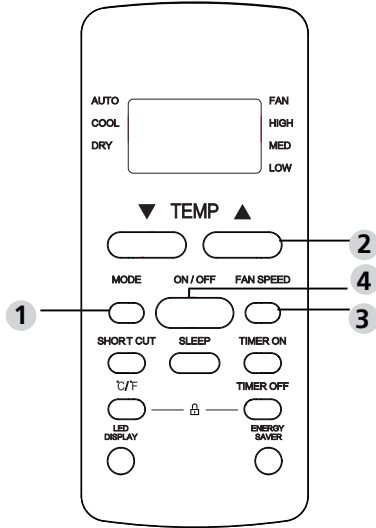

1. Press the **MODE** button to select **COOL** mode.
2. Set your desired temperature using the **TEMP ▲** or **TEMP ▼** button.
3. Press **FAN** button to select the fan speed: AUTO, LOW, MED, or HIGH.
4. Press the **ON/OFF** button to start the unit.

## SETTING TEMPERATURE

The operating temperature range for units is 62-86°F (17-30°C). You can increase or decrease the set temperature 1 °F (1°C) increments.

## AUTO Mode

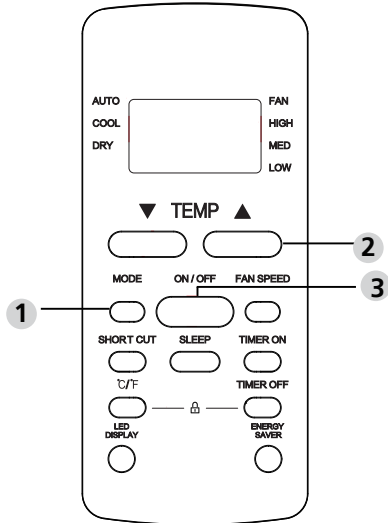

In AUTO mode, the unit will automatically select the COOL or FAN operation based on the set temperature.

1. Press the **MODE** button to select **AUTO**.
2. Set your desired temperature using the **TEMP ▲** or **TEMP ▼** button.
3. Press the **ON/OFF** button to start the unit.

**NOTE:** FAN SPEED can't be set in AUTO mode.

## FAN Mode

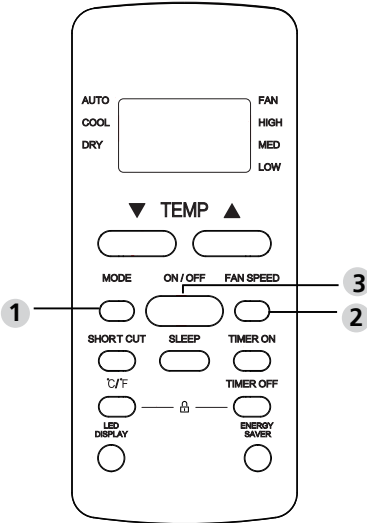

1. Press the **MODE** button to select **FAN** mode.
2. Press **FAN** button to select the fan speed: AUTO, LOW, MED, or HIGH.
3. Press the **ON/OFF** button to start the unit.

**NOTE:** You can't set temperature in FAN mode. As a result, your remote control's LCD screen will not display temperature.

## DRY Mode (dehumidifying)

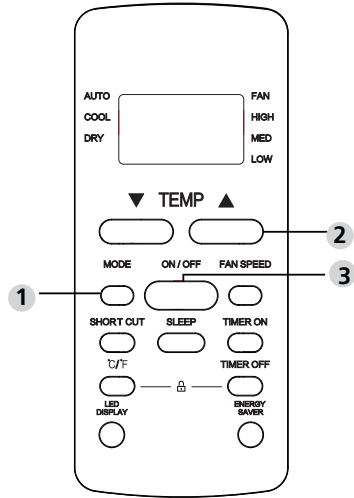

1. Press the **MODE** button to select **DRY**.
2. Set your desired temperature using the **TEMP ▲** or **TEMP ▼** button.
3. Press the **ON/OFF** button to start the unit.

**NOTE:** FAN SPEED cannot be changed in DRY mode.



## Setting the TIMER

**TIMER ON/OFF** - Set the amount of time after which the unit will automatically turn on/off.

### TIMER ON setting

Press TIMER ON button to initiate the ON time sequence.

Press the TEMP▲ or TEMP▼ button repeatedly to set the time when you want the unit to turn on.

Point the remote to the unit and wait 1 sec, then the TIMER ON function will be activated.

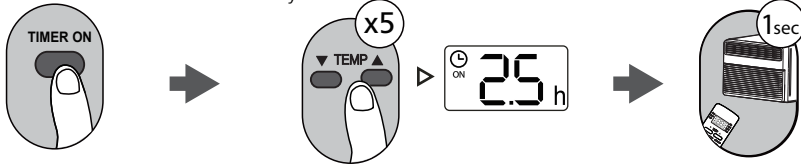

TEMP

### TIMER OFF setting

Press TIMER OFF button to initiate the OFF time sequence.

Press the TEMP▲ or TEMP▼ button repeatedly to set the time when you want the unit to turn off.

Point the remote to the unit and wait 1 sec, then the TIMER OFF function will be activated.

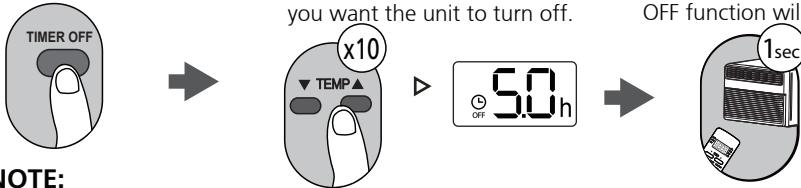

### NOTE:

1. When setting the TIMER ON or TIMER OFF, the time will increase by 30 minutes increments with each press, up to 10 hours. After 10 hours and up to 24, it will increase in 1 hour increments. (For example, press 5 times to get 2.5h, and press 10 times to get 5h.) The timer will revert to 0.0 after 24.
2. Cancel either function by setting its timer to 0.0h.

### TIMER ON & OFF setting(example)

Keep in mind that the time periods you set for both functions refer to hours after the current time.

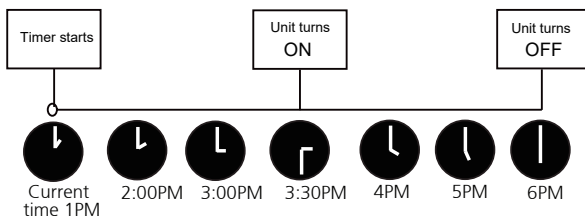
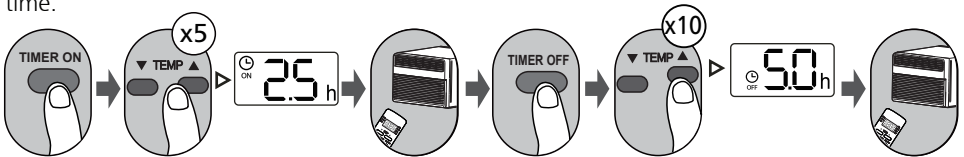

Example: If the current time is 1:00 PM and you set the timer as above, the unit will turn on 2.5h later at 3:30 PM and turn off at 6:00 PM.

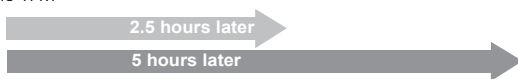

# How to Use Advanced Functions

## ENERGY SAVER function (On some models)



Press ENERGY SAVER button to initiate this function.

In this mode, the fan will continue to run for 3 minutes after the compressor shuts off. The fan then cycles on for 2 minutes at 10 minute intervals until the room temperature is above the set temperature, at which time the compressor turns back on and cooling starts.

## °C/°F (On some models)



Press this button to switch the temperature display from degrees Celsius (°C) to degrees Fahrenheit (°F)

## LED DISPLAY

Press LED button



Press this button to turn the indoor unit's LED display on and off.

## SHORTCUT function (On some models)

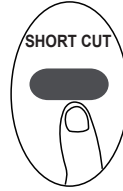

- Used to restore the current settings or resume previous settings.
- Push this button when remote control is on, the system will automatically revert back to the previous settings including operating mode, setting temperature, fan speed level, and sleep feature (if activated).
- By pressing for more than 2 seconds, the system will automatically restore the current operation settings including operating mode, setting temperature, fan speed level, and sleep feature (if activated).

## SLEEP function



The SLEEP function can be used to conserve energy during sleeping hours. This function can only be activated via remote control. The SLEEP function is not available in Fan or Dry mode. Please refer to the OWNER'S MANUAL for more details.



The design and specifications are subject to change without prior notice for product improvement.